

# MASTER PLAN SENATE AVENUE ZONE-V, ISLAMABAD

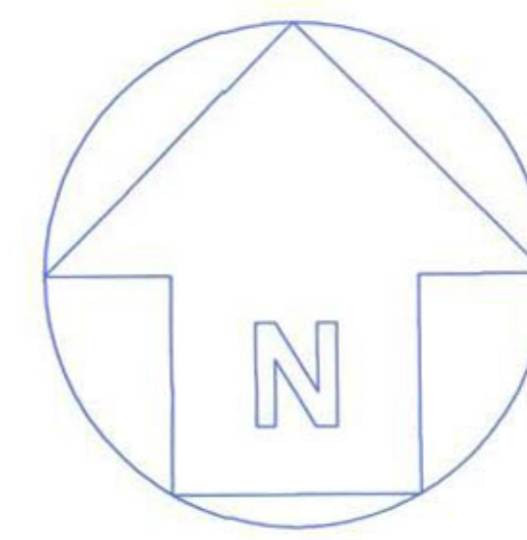

GATES



BUILDING LINES

1 Kanal Plots 10 Marla Plots  
 Front: 10'-0" Front: 5'-0"  
 Rear: 10'-0" Rear: 5'-0"  
 Sides: 5'-0" Sides: ---

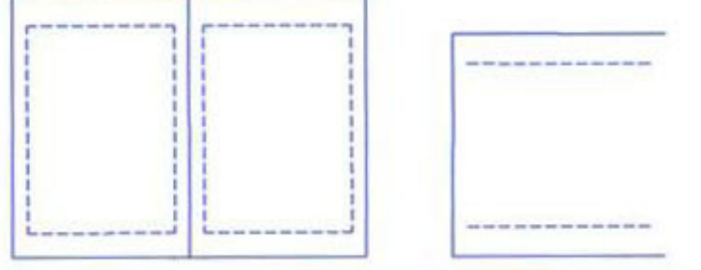

CHAMFERING OF PLOTS 5'-0"

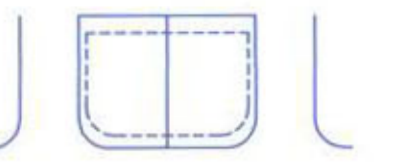

LAND USE DISTRIBUTION

Land Use	SENATE AVENUE		
	Area (Kanals)	%age	Remarks
Residential	364.77	53.65	NOT MORE 55%
Commercial	24.52	3.61	NOT MORE 5%
Open Spaces	57.63	8.48	NOT LESS 8%
Public Buildings	34.23	5.03	NOT LESS 4%
Roads & Streets	185.14	27.23	NOT LESS 26%
Grave Yard	13.61	2.00	NOT LESS 2%
	679.90	100.00	

DETAIL OF BLOCKS

SENATE AVENUE		
Blocks	Size of Plots	Nos
Block-A (242)	30'x60' 40'x80'	194 48
Block-B (82)	50'x90'	82
Block-C (177)	50'x90'	177
Block-D (68)	35'x70'	68

SCHEDULE OF PLOTS

DESCRIPTION	SENATE AVENUE
500 SQYDS (50'x90')	259
355.55 SQYDS (40'x80')	48
272.22 SQYDS (35'x70')	68
200 SQYDS (30'x60')	194
TOTAL PLOTS	569

Capital Development Authority  
Islamabad

PROJECT DEVELOPERS:

SENATE SECT. EMPLOYEES COOPERATIVE  
HOUSING SOCIETY, ISLAMABAD

Master Plan / Layout Plan

Town Planner:  
M. Kashif Chaudhry  
(MPCATP-0563)

*Kashif Chaudhry*  
Town Planner (P-0563)  
Regd. MPCATP  
Memb. MPCR

SCALE: -  
1:1000

CONSULTANTS

*SK*  
Suite-12, 2nd Floor,  
Bangsar Plaza, Commercial  
Market, Satellite Town  
Rawalpindi-051-4419675

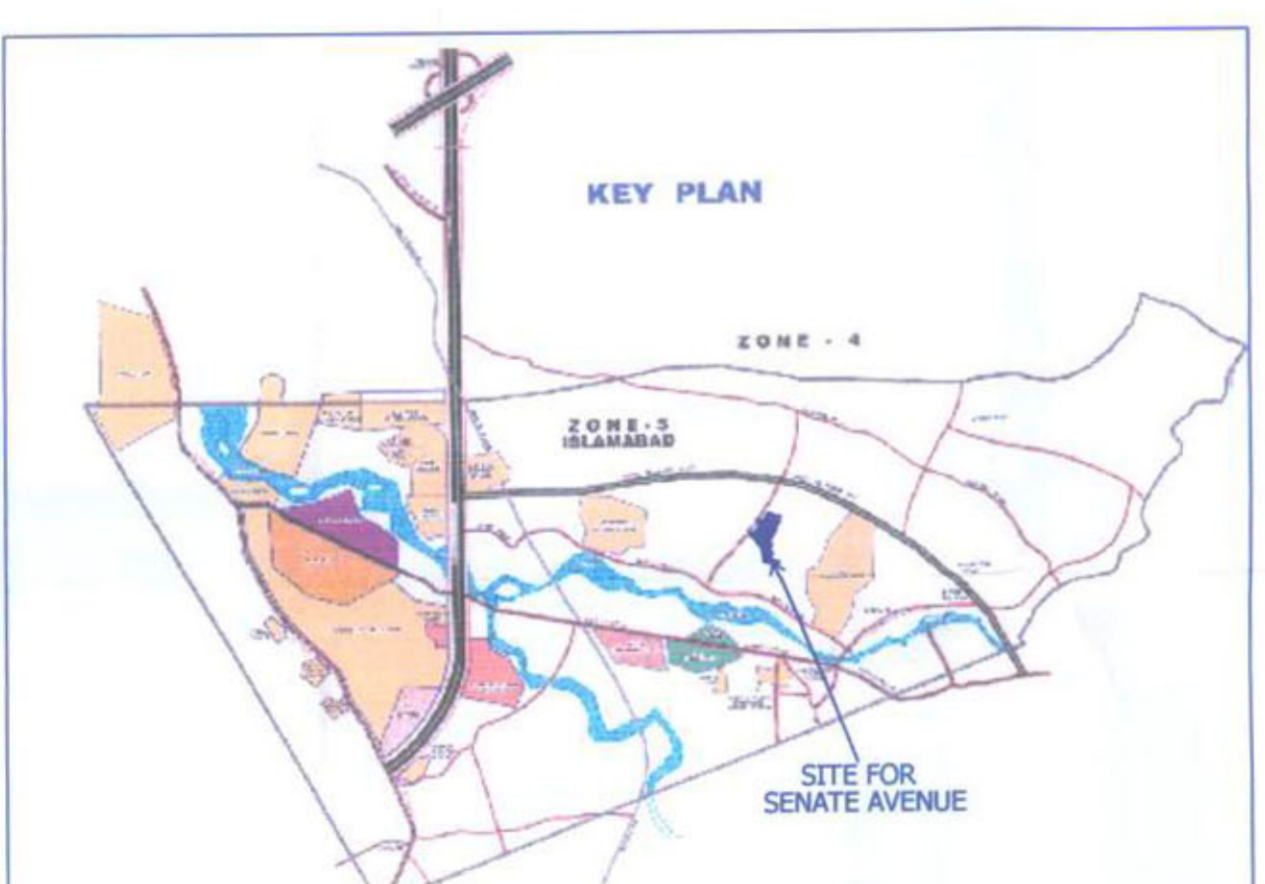
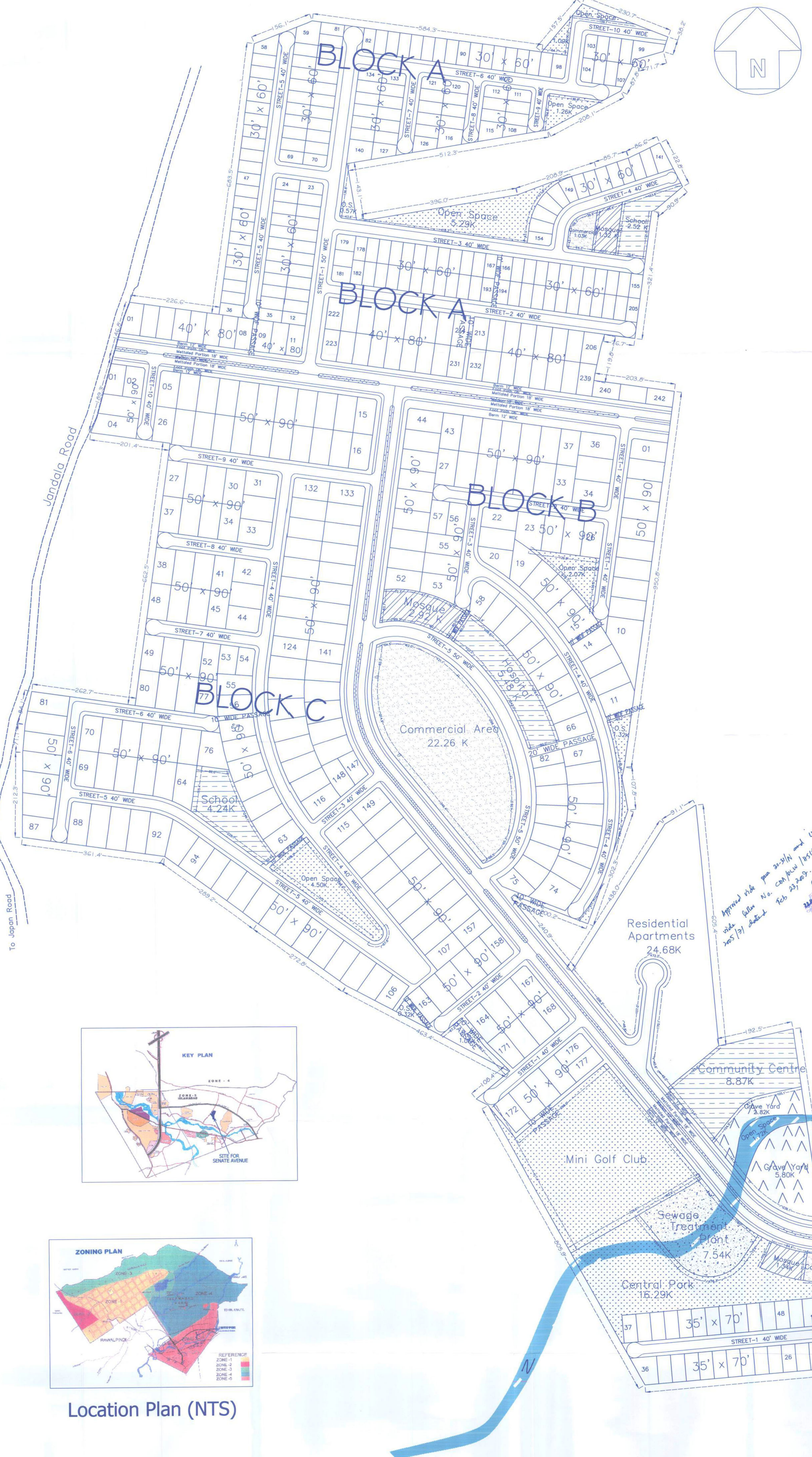

Location Plan (NTS)

TO GULSHAN-E-RABIA / JAPAN ROAD